



Chapter 105 General Permits

Michala Hart

March 21st & 22nd 2024

Westmoreland County Conservation District

Engineer's Workshop

Josh Shapiro, Governor

Jessica Shirley, Interim Acting Secretary

Topics

- Ch 105: General Overview
- Ch 105: General Permit Overview
- Ch 105 GP Registration Package Requirements & Common Mistakes
- PASPGP-6: Federal Authorization
- GP- 1, 3, 5, 7, 8, 11
- Submitting Applications to DEP
- Resources
- Questions

CH 105 Permitting Overview

- Chapter 105 regulations, requires permits for the construction, operation, or modification of water obstructions and or encroachments
 - “Regulated Waters” : Watercourses, streams or bodies of water (includes wetlands, natural and artificial ponds/lakes) and their floodways wholly or partly within or on the boundary of the Commonwealth.
 - Permits/authorizations issued under Ch 105 include: Joint Permit & Small Project Permits, Environmental Assessments, and General Permit Registrations.
 - Emergency Permits, Waiver Verifications Letters, and Permitting Determinations are also issued by DEP, for Ch 105 covered activities, as needed or requested
- Ch 105 General Permits are permits which have already been acknowledged by the Department. They are permits developed by DEP for smaller projects which meet general design standards, eligibility requirements and follow specific construction criteria for minimal resource impacts.
- When applying for a General Permit it is to register the project for use of the General Permit, for certain activities which are considered water obstructions and/or encroachments. All aspects of the project must meet all conditions of the respective GP registration to be eligible.

Ch 105 General Permit (GP) Overview

GP-1: Fish Habitat Enhancement Structures

GP-2: Small Docks & Boat Launching Ramps

GP-3: Bank Rehab., Protection & Gravel Bar Removal

GP-4: Intake & Outfall Structures

GP-5: Utility Line Stream Crossings

GP-6: Agricultural Crossings and Activities

GP-7: Minor Road Crossings

GP-8: Temporary Road Crossings

GP-9: Agricultural Activities

GP-10: Abandoned Mine Reclamation

GP-11: Maintenance, Testing, Repair, Rehab or Replacement of Existing Water Obstructions and Encroachments

GP-15: Private Residential Construction in Wetlands

- Ch 105 provides 11 different General Permits
 - 9- GPs are applicable in the Southwest Region
 - GP-10 issued by the Mining Program Only
 - GP-15 is not applicable for our region
- The Southwest Region of DEP has 6 delegated county conservation districts, for the Ch 105 program
- GP-11 is reviewed by Regional Office

Ch 105 General Permit (GP) Overview

- All GPs have associated conditions, eligibility & design criteria
 - These documents should be kept with the approved GP registration package, on-site, during construction. Applicant/Owner should review, understand, and retain these documents along with the GP registration package after construction is completed.
- GPs are perpetual authorizations however some GPs (7 & 8) have time restrictions for construction and/or removal
- GPs are attached to the property and should be transferred if the property is sold
- All GPs require an appropriate E&S plan to be reviewed and approved prior to construction

Ch 105 GP Registration Form

- GP Registration Form: 3150-PM-BWEW0500 Rev. 04/2021
- The GP Registration form is divided into 7 sections:
 - Section A: Applicant Information
 - Section B: Consultant Information
 - Section C: Project Information
 - **Section D: General Permit Checklist & Requirements**
 - **Section E: Proposed Impacts**
 - Section F: Certification
 - Section G: Decision/Disposition- Completed by DEP (not covered)

Ch 105 GP Registration Form

*Page 1:

• Section A: Applicant Information:

- include the Applicant EIN, if applicable
- Include email address for electronic notification

• Section B: Consultant Information:

- Include consultant EIN & email

• Section C: Project Information:

- Fill in completely
- One County only

3160-PM-SWEW0600 Rev. 4/2021
Form
pennsylvania
DEPARTMENT OF ENVIRONMENTAL PROTECTION
BUREAU OF WATERWAYS ENGINEERING AND WETLANDS

COMMONWEALTH OF PENNSYLVANIA
DEPARTMENT OF ENVIRONMENTAL PROTECTION
BUREAU OF WATERWAYS ENGINEERING AND WETLANDS

CHAPTER 105 WATER OBSTRUCTIONS AND ENCROACHMENT
GENERAL PERMIT REGISTRATION

SECTION A. APPLICANT INFORMATION					
<input type="checkbox"/> FERC Natural Gas Activity		Docket Number _____		Type of Facility _____	
Has a Water Quality Certification (WQC) request been sent to DEP? <input type="checkbox"/> Yes <input type="checkbox"/> No					
<input type="checkbox"/> Activity Subject to FERC approval and/or Oil & Gas Exploration, Production, Storage or Transmission if the activity is regulated by FERC and provide the FERC docket number.					
Applicant's Name / Client		DEP Client ID# (if known)		Employer ID# (EIN)	
Client Information - Please select Client Type / Code from drop down box under the correct entity shown below. (or may be written in) ↓					
Government		Non-Government		Individual	
Mailing Address		City		State	ZIP + 4
Contact Person - Last Name		First	MI	Suffix	Telephone ()
Email Address					
SECTION B. CONSULTANT INFORMATION (if applicable) <input type="checkbox"/> N/A					
Contact Person - Last Name		First	MI	Suffix	Consultants Title
Mailing Address		City		State	ZIP + 4
Telephone ()		Fax ()		Employer ID# (EIN)	
Email					
SECTION C. PROJECT INFORMATION					
Project / Site Name			DEP Site ID# (if known or leave blank)		
Client Relationship - Please select Site-to-Client Relationship / Code from drop down box to the right. (or may be written in) →			Double-click on shaded area below to select correct Site-to-Client Relationship / Code ↓		
County		Municipality	<input type="checkbox"/> City	<input type="checkbox"/> Borough	<input type="checkbox"/> Township
Site Location / Address		City		State	ZIP + 4
Collection Method: <input type="checkbox"/> EMAP <input type="checkbox"/> HGIS <input type="checkbox"/> GISDR* <input type="checkbox"/> ITPMP <input type="checkbox"/> GPS <input type="checkbox"/> WAAS <input type="checkbox"/> LORAN					
Check the horizontal reference datum (or projection datum) employed in the collection method.					
EMAP and HGIS (PNDI) have known datum and do not require checking here. <input type="checkbox"/> NAD27 <input type="checkbox"/> NAD83 <input type="checkbox"/> WGS84					
(GEO84) LAT.: _____		LONG.: _____			

Ch 105 GP Registration Form

*Page 2:

- **Section D: General Permit & Checklist**

- Mark Fee **Exemption** Box if applicable

- Municipalities, municipal authorities, state & federal agencies are exempt

- Mark all GPs to be registered and fill in details as needed; dollar amounts are not required for exempt applicants

*Note: GP-5 is per utility /per crossing; GP-11 has associated disturbance fees

3160-PM-BWEW0600 Rev. 4/2021
Form

SECTION D. REGISTRATION CHECKLIST AND REQUIREMENTS				
Please place an "X" next to each item (1-9) to ensure it is completed and/or provided. Unless otherwise specified, all items are <u>required</u> to ensure a complete Registration package. **Provide ONE (1) ORIGINAL and ONE (1) COPY of the Registration package** Please provide a copy of the Registration form to the Municipality & County in which the work will be performed. Proof of receipt is not required to be provided to DEP.				
1. REGISTERING A GENERAL PERMIT (GP) check all that apply Federal, State, county or municipal agencies or municipal authorities:				<input type="checkbox"/> EXEMPT from fees
<input type="checkbox"/>	GP-1	Fish Habitat Enhancement Structures..... Per Project	\$ 50	- \$ ____
<input type="checkbox"/>	GP-2	Small Docks and Boat Launching Ramps..... Per Dock / Ramp ____ (#) x	\$ 175	- \$ ____
<input type="checkbox"/>	GP-3	Bank Rehabilitation, Bank Protection and Gravel Bar Removal..... Per Project ____ (#) x	\$ 250	- \$ ____
<input type="checkbox"/>	GP-4	Intake and Outfall Structures..... Per Structure ____ (#) x	\$ 200	- \$ ____
<input type="checkbox"/>	GP-5	Utility Line Stream Crossings..... Per Individual Utility ____ (#) x ____ (#) x	\$ 250	- \$ ____
<input type="checkbox"/>	GP-6	Agricultural Crossings and Ramps..... Per Crossing / Ramp ____ (#) x	\$ 50	- \$ ____
<input type="checkbox"/>	GP-7	Minor Road Crossings?..... Per Crossing ____ (#) x	\$ 350	- \$ ____
<input type="checkbox"/>	GP-8	Temporary Road Crossings?..... Per Crossing ____ (#) x	\$ 175	- \$ ____
<input type="checkbox"/>	GP-9	Agricultural Activities..... Per Project	\$ 50	- \$ ____
<input type="checkbox"/>	GP-10	Abandoned Mine Reclamation..... Per Project	\$ 500	- \$ ____
<input type="checkbox"/>	GP-11	Maintenance, Testing, Repair, Rehabilitation, or Replacement of Water Obstructions and Encroachments ¹	\$ 750	+
<input type="checkbox"/>		Temporary Disturbance (\$400/0.1ac)..... acres x \$4,000 =	\$ ____	+
<input type="checkbox"/>		Permanent Disturbance (\$800/0.1ac)..... acres x \$8,000 =	\$ ____	- \$ ____
<input type="checkbox"/>	GP-15	Private Residential Construction in Wetlands ¹	\$ 750	+
<input type="checkbox"/>		Temporary Disturbance (\$400/0.1ac)..... acres x \$4,000 =	\$ ____	+
<input type="checkbox"/>		Permanent Disturbance (\$800/0.1ac)..... acres x \$8,000 =	\$ ____	- \$ ____

Ch 105 GP Registration Form

*Page 3 :

• **Section D: General Permit & Checklist**



• Refer to the GP Registration Form Instructions for requirements of each item under Section D. (D2.-D9.)

• Municipal/County Notifications still required to be sent for GPs but proof is not required to be submitted

3150-FM-BWEW0500 Rev. 4/2021
Form

	Applicant Entry	DEP Use Only
2. Location Map (USGS quad map) with project site marked:	<input type="checkbox"/>	<input type="checkbox"/>
3. Color Photographs with dates, locations, and descriptions: <input type="checkbox"/> GP-3 <input type="checkbox"/> GP-11 <input type="checkbox"/> N/A	<input type="checkbox"/>	<input type="checkbox"/>
4. Project Description: (Example: Linear pipeline project using multiple GP-5's and GP-8's; One GP-7 for an access road to my property) _____ _____	<input type="checkbox"/>	<input type="checkbox"/>
5. Site Specific and/or Standard Drawings are (required for all) project's GP activities. For Activities that qualify for GP-7 or GP-11 Plans, specifications, and reports for bridges and culverts across a stream which are to be used by the general public such as an access to an industrial, commercial or residential development, etc., shall be prepared by a registered professional engineer and shall be affixed with their seal and certification which shall read as follows on the drawings: If the project includes a bridge or culvert replacement or the proposed work will change the waterway opening, please complete and provide the <u>Bridge and/or Culvert Replacement Projects or Projects That Change the Waterway Opening (3150-FM-BWEW05526)</u> worksheet. If the project consists of similar work (replacement or change in waterway opening) on more than one structure, provide the data requested for each structure included in this Registration package. "I (name) do hereby certify pursuant to the penalties of 18 Pa. C.S.A. Sec. 4904 to the best of my knowledge, information and belief, that the information contained in the accompanying plans, specifications, and reports has been prepared in accordance with accepted engineering practice, is true and correct, and is in conformance with Chapter 105 of the rules and regulations of the Department of Environmental Protection."	<input type="checkbox"/>	<input type="checkbox"/>
6. Proposed Project Purpose depicting the site of the project's GP activities and impacts. Briefly discuss the need for the authorization.	<input type="checkbox"/>	<input type="checkbox"/>
7. Erosion & Sediment Control Plan (E&S Plan) (Required for all GP's but specifically required with submission with a registration of GP-11 or GP's for oil and gas related activities submitted to DEP.)	<input type="checkbox"/>	<input type="checkbox"/>
8. Pennsylvania Natural Diversity Inventory (PNDI): PNDI Search Receipt and clearance letters, if available. See additional requirements for submission with Avoidance Measures and/or Potential Impacts.	<input type="checkbox"/>	<input type="checkbox"/>
9. Activities which impact wetlands: (For State Regulated Impacts) Please place an "X" next to the appropriate box indicating the information provided: <ul style="list-style-type: none"> > N/A because no wetland impacts are proposed or no compensatory mitigation is necessary. <input type="checkbox"/> > A wetland delineation with complete data sheets in accordance with the 1987 Corps of Engineers Wetland Delineation Manual AND the appropriate Regional Supplements to the Corps of Engineers Wetland Delineation Manual for use in Pennsylvania. <input type="checkbox"/> > If direct or indirect wetland impacts are greater than 0.05 acre, a compensatory mitigation plan in accordance with the Department's Replacement criteria which provides compensation for both affected acreage, and functions at a minimum of one to one ratio. <input type="checkbox"/> > If compensatory mitigation onsite is determined not feasible: A check, number _____, in the amount of \$ _____ payable to the National Fish and Wildlife Foundation, N.A. 1237, as compensatory mitigation for _____ acres of impact in wetlands, in accordance with the Pennsylvania Wetland Replacement Project. <input type="checkbox"/> (Additional Mitigation May Be Required by U.S. Army Corps) <input type="checkbox"/>	<input type="checkbox"/>	<input type="checkbox"/>
NOTE: If the Pennsylvania Wetland Replacement Fund is proposed to be used as compensatory mitigation for waters of the Commonwealth the U.S. Army Corps of Engineers may also require additional mitigation if the proposed activity impacts waters of the United States.		

Ch 105 GP Registration Form

*Page 3 :

• Section D: General Permit & Checklist

- D4. Project Description should be specific to the activities being registered under the Ch 105 General Permit
 - Include any identified PNDI Avoidance Measures



3150-FM-BWEW0600 Rev. 4/2021
Form

	Applicant Entry	DEP Use Only
2. Location Map (USGS quad map) with project site marked:	<input type="checkbox"/>	<input type="checkbox"/>
3. Color Photographs with dates, locations, and descriptions: <input type="checkbox"/> GP-3 <input type="checkbox"/> GP-11 <input type="checkbox"/> N/A	<input type="checkbox"/>	<input type="checkbox"/>
4. Project Description: (Example: Linear pipeline project using multiple GP-5's and GP-8's; One GP-7 for an access road to my property) _____ _____	<input type="checkbox"/>	<input type="checkbox"/>
5. Site Specific and/or Standard Drawings are (required for all) project's GP activities. For Activities that qualify for GP-7 or GP-11 Plans, specifications, and reports for bridges and culverts across a stream which are to be used by the general public such as an access to an industrial, commercial or residential development, etc., shall be prepared by a registered professional engineer and shall be affixed with their seal and certification which shall read as follows on the drawings: If the project includes a bridge or culvert replacement or the proposed work will change the waterway opening, please complete and provide the <u>Bridge and/or Culvert Replacement Projects or Projects That Change the Waterway Opening (3150-FM-BWEW05526)</u> worksheet. If the project consists of similar work (replacement or change in waterway opening) on more than one structure, provide the data requested for each structure included in this Registration package. "I (name) do hereby certify pursuant to the penalties of 18 Pa. C.S.A. Sec. 4904 to the best of my knowledge, information and belief, that the information contained in the accompanying plans, specifications, and reports has been prepared in accordance with accepted engineering practice, is true and correct, and is in conformance with Chapter 105 of the rules and regulations of the Department of Environmental Protection."	<input type="checkbox"/>	<input type="checkbox"/>
6. Proposed Project Purpose depicting the site of the project's GP activities and impacts. Briefly discuss the need for the authorization.	<input type="checkbox"/>	<input type="checkbox"/>
7. Erosion & Sediment Control Plan (E&S Plan) (Required for all GP's but specifically required with submission with a registration of GP-11 or GP's for oil and gas related activities submitted to DEP.)	<input type="checkbox"/>	<input type="checkbox"/>
8. Pennsylvania Natural Diversity Inventory (PNDI): PNDI Search Receipt and clearance letters, if available. See additional requirements for submission with Avoidance Measures and/or Potential Impacts.	<input type="checkbox"/>	<input type="checkbox"/>
9. Activities which impact wetlands: (For State Regulated Impacts) Please place an "X" next to the appropriate box indicating the information provided: <ul style="list-style-type: none"> > N/A because no wetland impacts are proposed or no compensatory mitigation is necessary. <input type="checkbox"/> > A wetland delineation with complete data sheets in accordance with the 1987 Corps of Engineers Wetland Delineation Manual AND the appropriate Regional Supplements to the Corps of Engineers Wetland Delineation Manual for use in Pennsylvania. <input type="checkbox"/> > If direct or indirect wetland impacts are greater than 0.05 acre, a compensatory mitigation plan in accordance with the Department's Replacement criteria which provides compensation for both affected acreage, and functions at a minimum of one to one ratio. <input type="checkbox"/> > If compensatory mitigation onsite is determined not feasible: A check, number _____, in the amount of \$ _____ payable to the National Fish and Wildlife Foundation, N.A. 1237, as compensatory mitigation for _____ acres of impact in wetlands, in accordance with the Pennsylvania Wetland Replacement Project. <input type="checkbox"/> (Additional Mitigation May Be Required by U.S. Army Corps) <input type="checkbox"/>	<input type="checkbox"/>	<input type="checkbox"/>
NOTE: If the Pennsylvania Wetland Replacement Fund is proposed to be used as compensatory mitigation for waters of the Commonwealth the U.S. Army Corps of Engineers may also require additional mitigation if the proposed activity impacts waters of the United States.		

Ch 105 GP Registration Form

***Page 2 Continued:**

- **Section D: General Permit & Checklist**
- **Site Plans (standard drawings)/Project Purpose (D5. & D6.)**
 - Site Plans should have/include the following:
 - A. Show all floodplains, floodways (assumed or FEMA defined), watercourses, wetlands (delineated)
 - B. Existing roads, Utl lines, lots, other manmade structures; contours and drainage patterns
 - C. Proposed structure or activities, with labels (match ARIT)
 - D. Scale 1in. = 200 ft or >
 - E. North Arrow
 - F. Persons who prepared & applicant names (with date)
 - G. Cross-sectional view: before & after (existing and proposed)
 - H. *Unique Label for each impact which corresponds to Impact Table in Section E.*
- **Project Purpose should depict all of the activities being registered**

Ch 105 GP Registration Form

- Site Plan Examples (standard drawings)

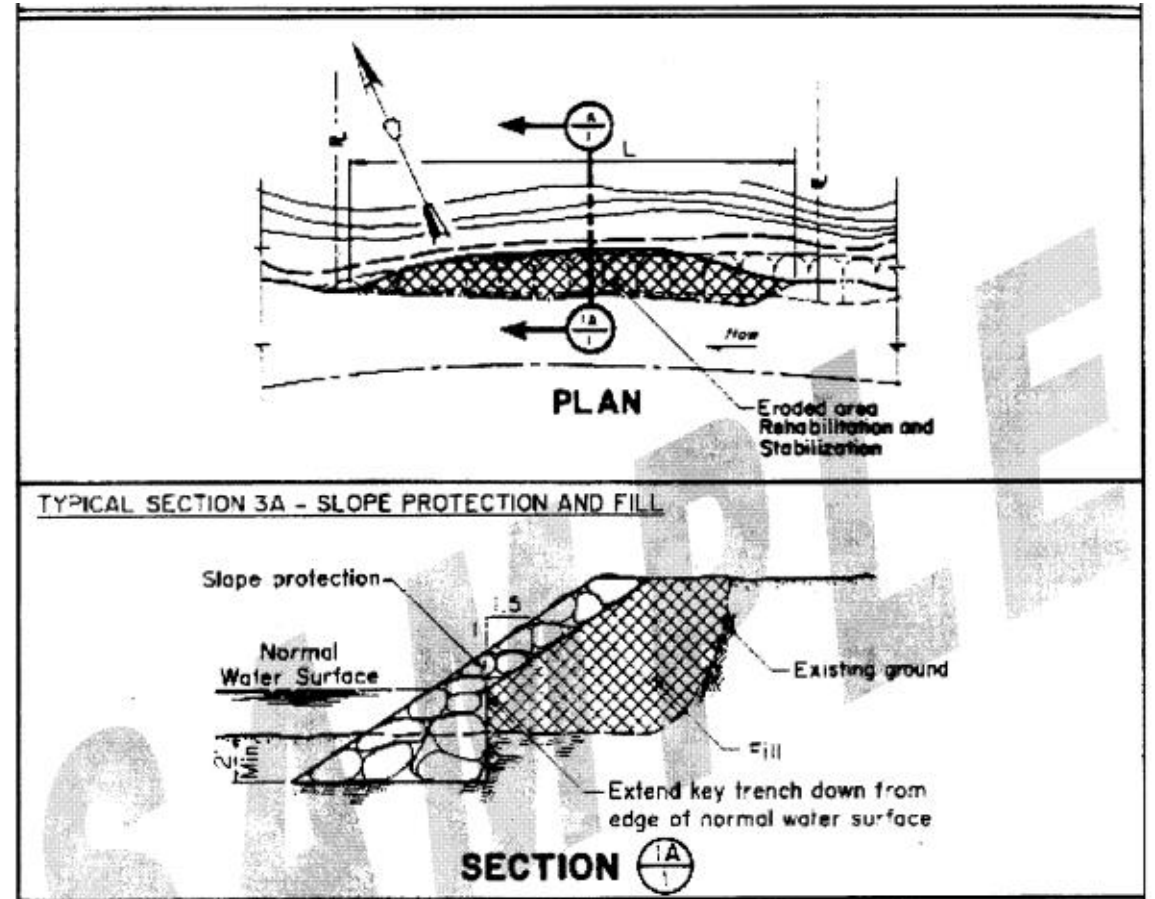
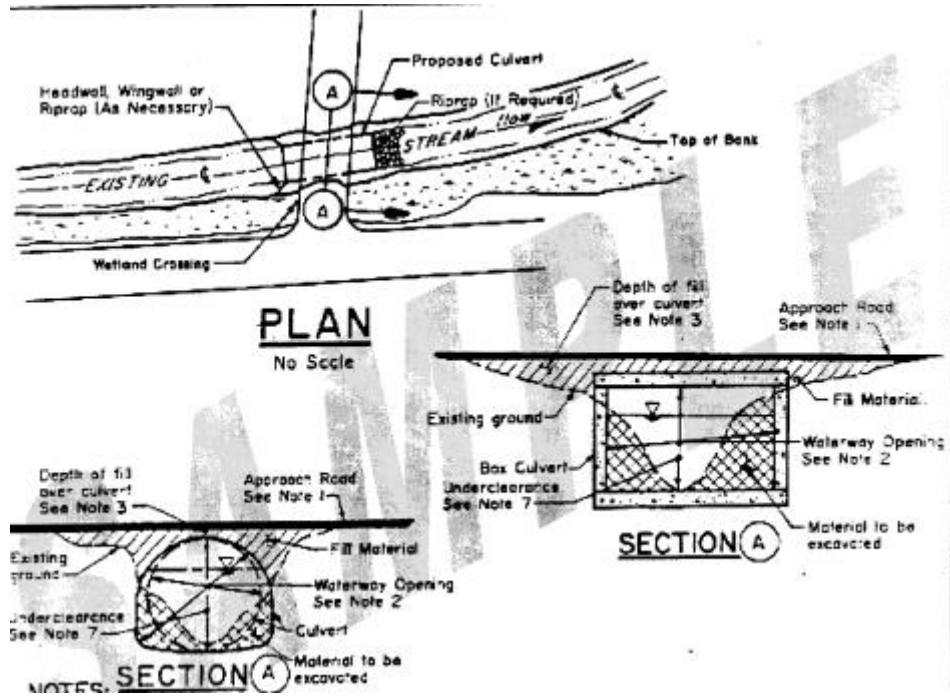

Ch 105 GP Registration Form

*Page 3 :

- **Section D: General Permit & Checklist**
- **D7. Erosion & Sediment Control Plan**
 - Identify E&S BMPs on GP Site Plan
- **D8. PNDI**
 - Choose an appropriate project type for the GP activities (use main GP)
- **D9. Wetlands**
 - All registrations should show verification of the presence or absence of wetlands at the site of the GP activities.

3150-FM-BWEW0500 Rev. 4/2021
Form

	Applicant Entry	DEP Use Only
2. Location Map (USGS quad map) with project site marked:	<input type="checkbox"/>	<input type="checkbox"/>
3. Color Photographs with dates, locations, and descriptions: <input type="checkbox"/> GP-3 <input type="checkbox"/> GP-11 <input type="checkbox"/> N/A	<input type="checkbox"/>	<input type="checkbox"/>
4. Project Description: (Example: Linear pipeline project using multiple GP-5's and GP-8's; One GP-7 for an access road to my property)	<input type="checkbox"/>	<input type="checkbox"/>
5. Site Specific and/or Standard Drawings are (required for all) projects GP activities. For Activities that qualify for GP-7 or GP-11 Plans, specifications, and reports for bridges and culverts across a stream which are to be used by the general public such as an access to an industrial, commercial or residential development, etc., shall be prepared by a registered professional engineer and shall be affixed with their seal and certification which shall read as follows on the drawings: If the project includes a bridge or culvert replacement or the proposed work will change the waterway opening, please complete and provide the <u>Bridge and/or Culvert Replacement Projects or Projects That Change the Waterway Opening (3150-FM-BWEW05526)</u> worksheet. If the project consists of similar work (replacement or change in waterway opening) on more than one structure, provide the data requested for each structure included in this Registration package. "I (name) do hereby certify pursuant to the penalties of 18 Pa. C.S.A. Sec. 4904 to the best of my knowledge, information and belief, that the information contained in the accompanying plans, specifications, and reports has been prepared in accordance with accepted engineering practice, is true and correct, and is in conformance with Chapter 105 of the rules and regulations of the Department of Environmental Protection."	<input type="checkbox"/>	<input type="checkbox"/>
6. Proposed Project Purpose depicting the site of the projects GP activities and impacts. Briefly discuss the need for the authorization.	<input type="checkbox"/>	<input type="checkbox"/>
7. Erosion & Sediment Control Plan (E&S Plan) (Required for all GP's but specifically required with submission with a registration of GP-11 or GP's for oil and gas related activities submitted to DEP.)	<input type="checkbox"/>	<input type="checkbox"/>
8. Pennsylvania Natural Diversity Inventory (PNDI): PNDI Search Receipt and clearance letters, if available. See additional requirements for submission with Avoidance Measures and/or Potential Impacts.	<input type="checkbox"/>	<input type="checkbox"/>
9. Activities which impact wetlands: (For State Regulated Impacts) Please place an "X" next to the appropriate box indicating the information provided: > N/A because no wetland impacts are proposed or no compensatory mitigation is necessary. > A wetland delineation with complete data sheets in accordance with the 1987 Corps of Engineers Wetland Delineation Manual AND the appropriate Regional Supplements to the Corps of Engineers Wetland Delineation Manual for use in Pennsylvania. > If direct or indirect wetland impacts are greater than 0.05 acre, a compensatory mitigation plan in accordance with the Department's Replacement criteria which provides compensation for both affected acreage, and functions at a minimum of one to one ratio. > If compensatory mitigation onsite is determined not feasible: A check, number _____, in the amount of \$ _____ payable to the National Fish and Wildlife Foundation, N.A. 1237, as compensatory mitigation for _____ acres of impact in wetlands, in accordance with the Pennsylvania Wetland Replacement Project. (Additional Mitigation May Be Required by U.S. Army Corps)	<input type="checkbox"/> <input type="checkbox"/> <input type="checkbox"/> <input type="checkbox"/> <input type="checkbox"/>	<input type="checkbox"/> <input type="checkbox"/> <input type="checkbox"/> <input type="checkbox"/> <input type="checkbox"/>
NOTE: If the Pennsylvania Wetland Replacement Fund is proposed to be used as compensatory mitigation for waters of the Commonwealth the U.S. Army Corps of Engineers may also require additional mitigation if the proposed activity impacts waters of the United States.		

Ch 105 GP Registration Form

- *Pg. 4
- Section E: Aquatic Resource Impact Table (ARIT)
- Permanent Impact vs Temporary Impact
- ACOE Impacts vs DEP Impacts
 - HDD/Bore Projects
- Right of Ways

3150-PM-BWEW0500 Rev. 4/2021
Form

SECTION E. PROPOSED IMPACTS

NOTE: Form 3150-PM-BWEW0557 or equivalent must be printed and submitted under this Section.

3150-PM-BWEW0557 Rev. 4/2018
Application
Pennsylvania
DEPARTMENT OF ENVIRONMENTAL PROTECTION
BUREAU OF WATERWAYS ENGINEERING AND WETLANDS

COMPARISON OF PENNSYLVANIA
DEPARTMENT OF ENVIRONMENTAL PROTECTION
BUREAU OF WATERWAYS ENGINEERING AND WETLANDS

AQUATIC RESOURCE IMPACT TABLE
FOR PENNSYLVANIA CHAPTER 105 WATER OBSTRUCTION AND ENCROACHMENT APPLICATION / REGISTRATION

Applicant's Name / Client _____

Project / SIA Name: DEP USE ONLY	Project Information										Date:			
	Agency Creating Number	Agency Creating File	Structure/ Water Method	Aquatic Resource Type	Latitude of center	Longitude of center	Water Years	At-Catch Channel ID Designation	Non- Proposed	Size Impact Area/ sq ft	Watercourse Type of Bank Material Type Length in feet	Watercourse Type of Bank Material Type Length in feet	Watercourse Type of Bank Material Type Length in feet	Watercourse Type of Bank Material Type Length in feet

PADEP Impact Type: temporary or permanent.

Permanent Impacts are those areas affected by a water obstruction or encroachment that consist of both direct and indirect impacts that result from the permanent or construction of a water obstruction or encroachment and include areas necessary for the operation and maintenance of the water obstruction or encroachment located in, along or across, or projecting into a watercourse, roadway or body of water.

Temporary Impacts are those areas affected during the construction of a water obstruction or encroachment that consists of both direct and indirect impacts located in, along or across, or projecting into a watercourse, roadway or body of water that are restored upon completion of construction. This does not include areas that will be in, along or across, or projecting into a watercourse, roadway or body of water that are considered permanent impacts.

-4-

Ch 105 GP Registration Form

3150-PM-BWEW0557 Rev 6/2021

Application Example



COMMONWEALTH OF PENNSYLVANIA
DEPARTMENT OF ENVIRONMENTAL PROTECTION
BUREAU OF WATERWAYS ENGINEERING AND WETLANDS

Applicant's Name / Client _____

AQUATIC RESOURCE IMPACT TABLE FOR PENNSYLVANIA CHAPTER 105 WATER OBSTRUCTION AND ENCROACHMENT APPLICATION / REGISTRATION

Project / Site Name: _____ Example Project _____		Date: _____ 2021 _____												
DEP USE ONLY	Project Information						PA DEP / 105						Enter Only If Different from DEP Impacts Army Corps Impacts:	
PADEP Permit Number	Structure / Activity unique identifier	Aquatic Resource Type	Latitude dd nad83	Longitude dd nad83	Waters Name	PA Code Chapter 93 Designation	Work Proposed	DEP Impact Type temp/perm	ACOE Impact Type temp/perm	Watercourse Impact Top of Bank to Top of Bank Length and Width in feet	Floodway Impact Top of Bank Landward Length and Width in feet	Wetland Impact Dimensions Length and Width in feet	Watercourse Impact Length and Width in feet	Wetland Impact Length and Width in feet
	GP-5-1	Perennial	41.7710531	77.152930	Dunn Creek	CWF	Excavation/Utility Line	Perm	Temp	50 - 30	100 - 30	N/A		
	GP-5-1	Perennial	41.7710531	77.152930	Dunn Creek	CWF	Excavation	Perm	Temp	N/A	100 - 30	N/A		
	GP-5-2	Perennial	41.7710589	77.152985	Dunn Creek	CWF	Directional Bore	Perm	N/A	40 - 30	100 - 30	N/A	0	
	GP-5-3	Topographic slope, Mineral (SLtn)	41.7710618	77.152945		Other	Excavation	Perm	Temp	N/A	N/A	10 - 30		
	GP-5-3	Topographic slope, Mineral (SLtn)	41.7710618	77.152945		Other	Excavation	Temp	Temp	N/A	N/A	10 - 10		
	GP-7-1	Perennial	41.7710618	77.152945	Dunn Creek	CWF	Excavation	Perm	Perm	20 - 30	100 - 30	N/A		

NOTE: Form 3150-PM-BWEW0557 or equivalent must be printed/submitted for this General Permit Registration or Joint Permit Application.

Ch 105 GP Registration Form

- *Pg. 5
- Section F: Certification
 - Application should be signed by the appropriate person/party as outlined by the Ch 105 GP Registration Form Instructions

3160-PM-BWEW0500 Rev. 4/2021
Form

SECTION F. CERTIFICATION

I certify under penalty of law that the information provided in this permit registration is true and correct to the best of my knowledge and information and that I possess the authority to undertake the proposed action. I am aware that there are significant penalties for submitting false information, including the possibility of fine and imprisonment for knowing violations. (If any of the information and/or plans is found to be in error, falsified, and/or incomplete, this authorization/verification may be subject to modification, suspension, or revocation in accordance with applicable regulations.) I further certify that this project complies with all the conditions of the general permit.

Signature of Applicant / Owner _____

Date _____

Typed / Printed Name _____

Typed / Printed Title _____

This General Permit shall not be effective until the owner has had their E&S Plan reviewed by the appropriate Regional Office or District, and, where required, obtained an SLLA from DEP.

THIS ACKNOWLEDGED COPY OF THIS GENERAL PERMIT REGISTRATION PACKAGE AND THE E&S PLAN MUST BE AVAILABLE AT THE PROJECT SITE DURING CONSTRUCTION.

SECTION G. DECISION / DISPOSITION – COMPLETED BY DEP

Decision Review:

DEP / District Reviewer Signature _____

GP _____

Reviewer's Typed / Printed Name _____

GP _____

NOTE: See Aquatic Resource Impact Table for any additional authorizations.

Disposition Status

Comments

ACKNOWLEDGED Date _____
SLLA Required Yes Attached No

INCOMPLETE / DEFICIENCY Date _____

EXTENSION REQUEST Date _____

WITHDRAWN Date _____

NOTE: If the GP registration information is incomplete a copy of this registration form and requested additional information will be sent to the applicant. A copy of the returned registration form and additional information must be re-submitted within 60 calendar days unless extended by the extension date listed above.

FEDERAL AUTHORIZATION

Non-reporting PASPGP verification / authorization attached.

Reporting – A copy of this General Permit registration package has been sent to the U.S. Army Corps of Engineers. Separate federal authorization may be required.

NOTE: Please be advised that if the reporting box is checked you do not have Federal authorization for this project and such authorization may be required prior to starting your project. In accordance with Section 404 of the Clean Water Act, a Department of the Army authorization is required for the discharge of dredged and/or fill material into waters of the United States, including jurisdictional wetlands. Section 10 of the Rivers and Harbors Act also requires Department of the Army authorization for any work in, over, or under a navigable water of the United States. In accordance with procedures established with the U.S. Army Corps of Engineers, you will be contacted directly by the Corps regarding Federal Authorization.

PASPGP- Federal Authorization

- Most GP projects also require federal authorization (stream/wetland impacts)
 - ACOE Does NOT regulate the Floodway/Floodplain; DEP Does
- DEP issues federal authorizations for non-reporting projects, as outlined in the Pennsylvania State Programmatic General Permit (PASPGP)- issued by the Army Corps of Engineers
 - currently in its 6th iteration (PASPGP-6)
- Most Ch 105 GPs have the same general eligibility requirements for PASPGP authorization:
 - <1.0 acre of temporary impacts and/or <0.25 of permanent impacts (cumulative)
 - GP-1 differs slightly
- Other scenarios as outlined in the PASPGP-6 permit would make a project reporting to the ACOE
 - Other Common Reporting Projects: Section 10 Waterways or federally endangered species
- Early coordination with ACOE is essential; IF known a project will be reporting you are encouraged to permit your project directly through the Corps to save time

GP-1 Fish Habitat Enhancement Structures

- **GP-1 Requirements**
- **Project Scope & Eligibility Requirements**



GP-1 Fish Habitat Enhancement Structures

- **GP-1 Requirements**
 - Structure Designs require prior PAFBC approval
 - PAFBC provides a letter to be submitted with GP-1 Registration Package



GP-1 Fish Habitat Enhancement Structures

Project Scope & Eligibility:

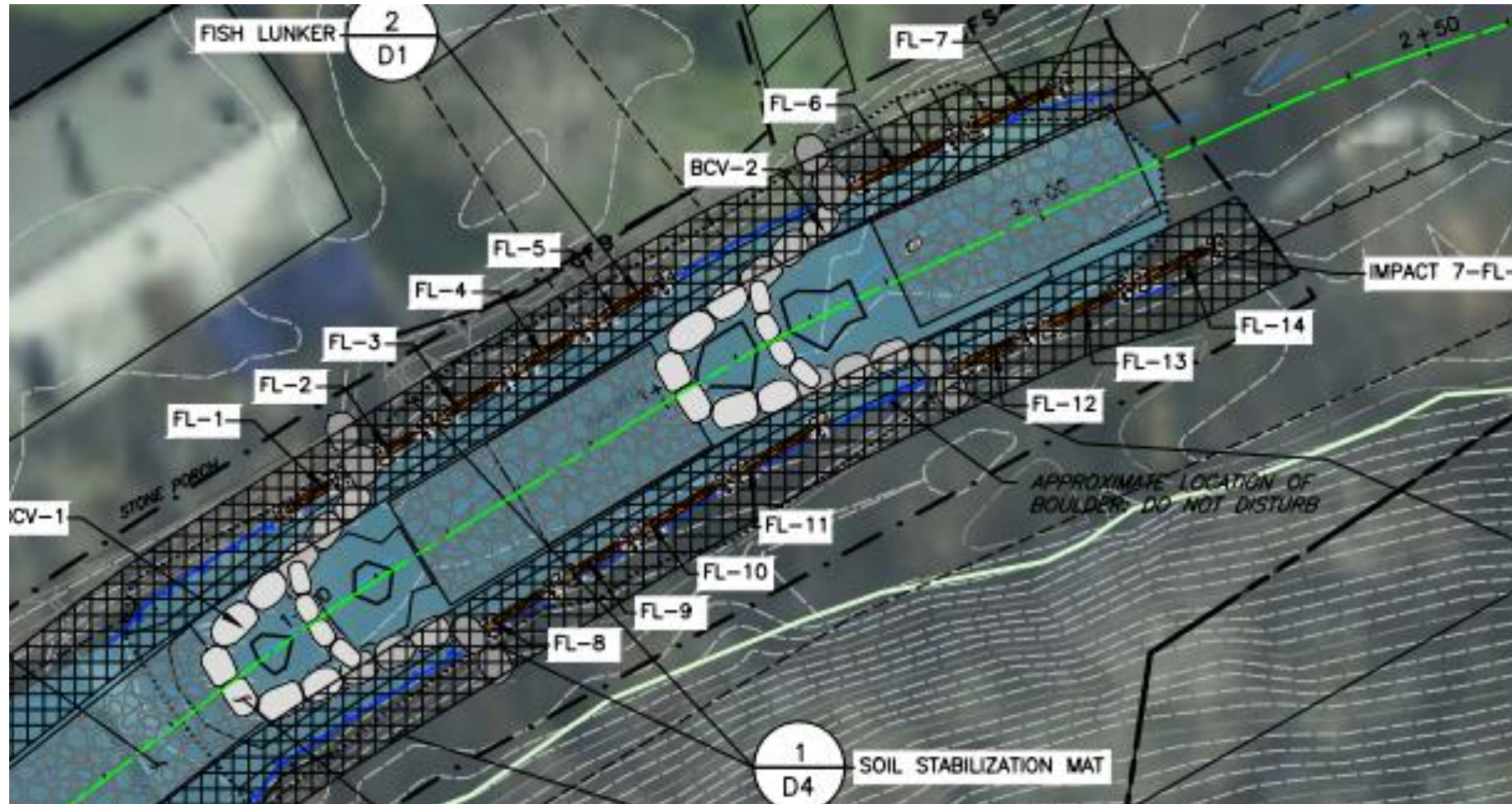

GP-1 Fish Habitat Enhancement Structures

- Project Scope

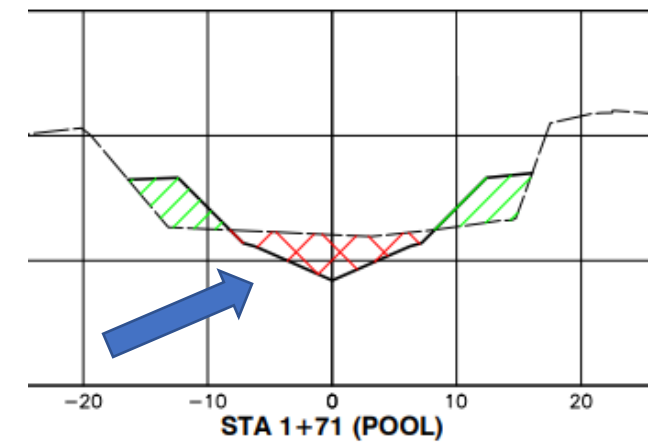
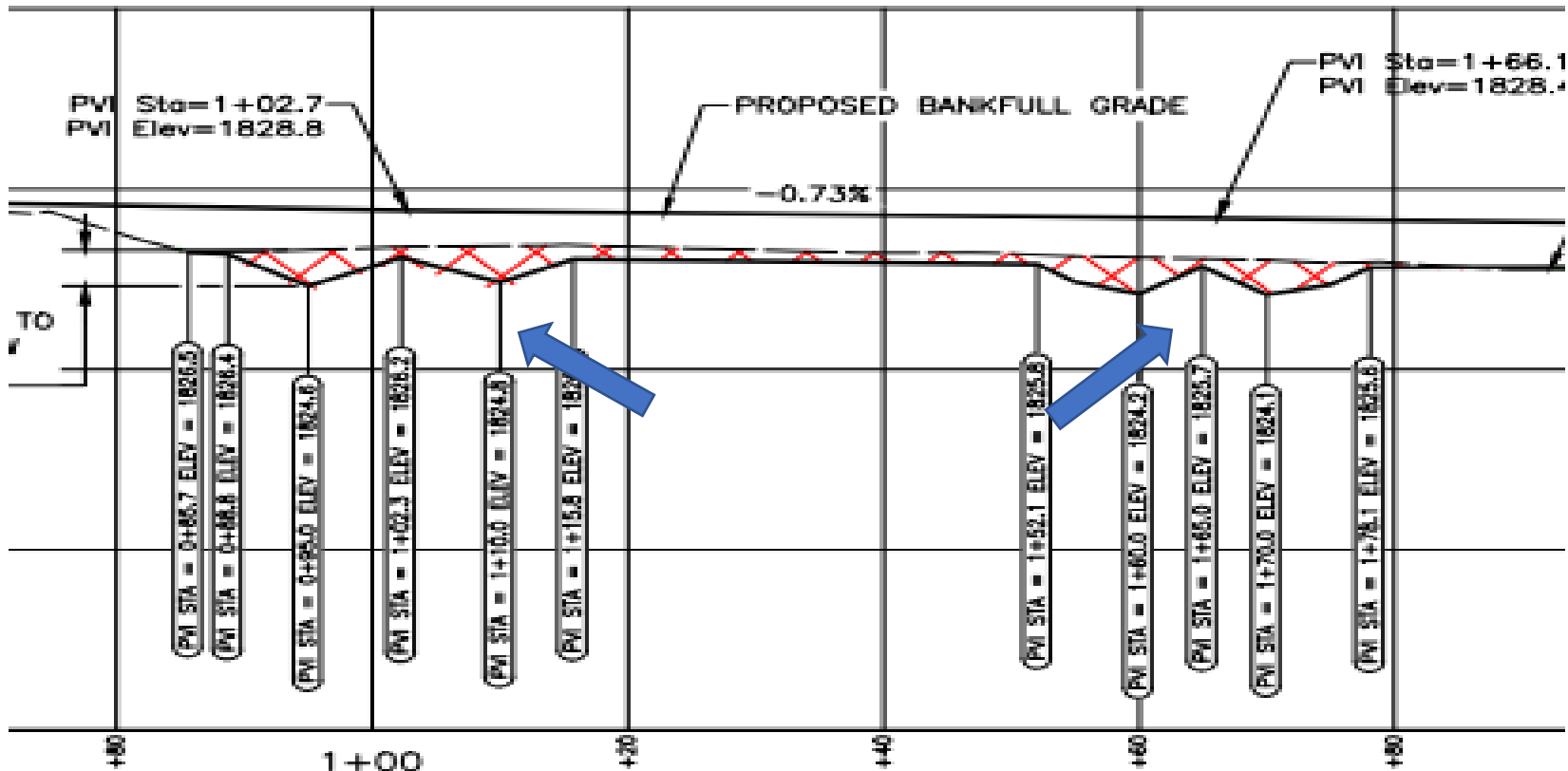

LEGEND

- PROPOSED GRADE
- - - APPROXIMATE EXISTING GROUND SURFACE
- /// PROPOSED COMPACTED FILL
- XXX PROPOSED EXCAVATION

▶ GP-03 Bank Rehab, Bank Protection & Gravel Bar Removal

- **Common Issues**
 - **Bank Stabilization Projects**
 - **“Gravel Bar” Removal Projects**
 - **Slope/Bank Protection Projects**
- **PNDI Project Types for GP-3**
 - **Habitat Conservation: Streambank Stabilization (w/riprap, if applicable) for Bank Stabilization and/or protection projects**
 - **In-Stream Activities: Gravel Bar Removal**



GP-3 Common Issues- Bank Stabilization Projects

- **Bank Stabilization Projects**

- 6' Height Limit ~ avoid gabion baskets for long-term stabilization in H₂O
- Typical Design Drawings available

Eligibility:

- No Tires in Design
- 500 LF or less



GP-3 Common Issues: Gravel Bar Removal Projects

- **Gravel Bar Removal Projects**

- Bank Stabilization or Protection component?
- Vegetation Present?
- Removal to Normal Water Line (pre-storm)

- **Eligibility**

- No EV Streams
- No Vegetated Gravel Bars



GP-3 Common Issues: Bank/Slope Protection Projects

- **Bank Protection Projects**

- Use of RipRap
- Bank Deflectors



GP-05 Utility Line Crossing

- Common Issues
 - HDD vs Excavation
 - IR/PPC plans
 - New Utility Crossing vs Replacement Projects
 - Extension Projects
 - Multiple-crossing Linear Projects



GP-05 Common Issues

- HDD vs Excavation
 - Impacts for Excavation
 - Traditional Boring vs HDD
 - IR/PPC plans for HDD
- Replacement Projects
 - Abandonment?
 - Existing crossings
- Extension Projects
 - Impacts associated with existing line/ tie-in points
- Linear Projects w Multiple Crossings
 - Site Plans
 - Replacement Project?



GP-07 Minor Road Crossing



- Common Issues
 - Design
 - Site Limitations
- GP-7 Eligibility

GP-07 Common Issues

- **Design**
 - Existing/After-the Fact projects or Replacements using GP-7
 - Typical Drawings
 - Least impactful design
 - Fill restrictions for culverts
 - Depressed Culverts
 - Stream Continuity



GP-07 Common Issues

- Site Limitations
 - **Scope of Project**
 - Resource Features

**Project Scope Not Eligible
for GP-7**



GP-07 Common Issues

- Site Limitations
 - Scope of Project
 - Resource Features

Design Not Eligible for GP-7

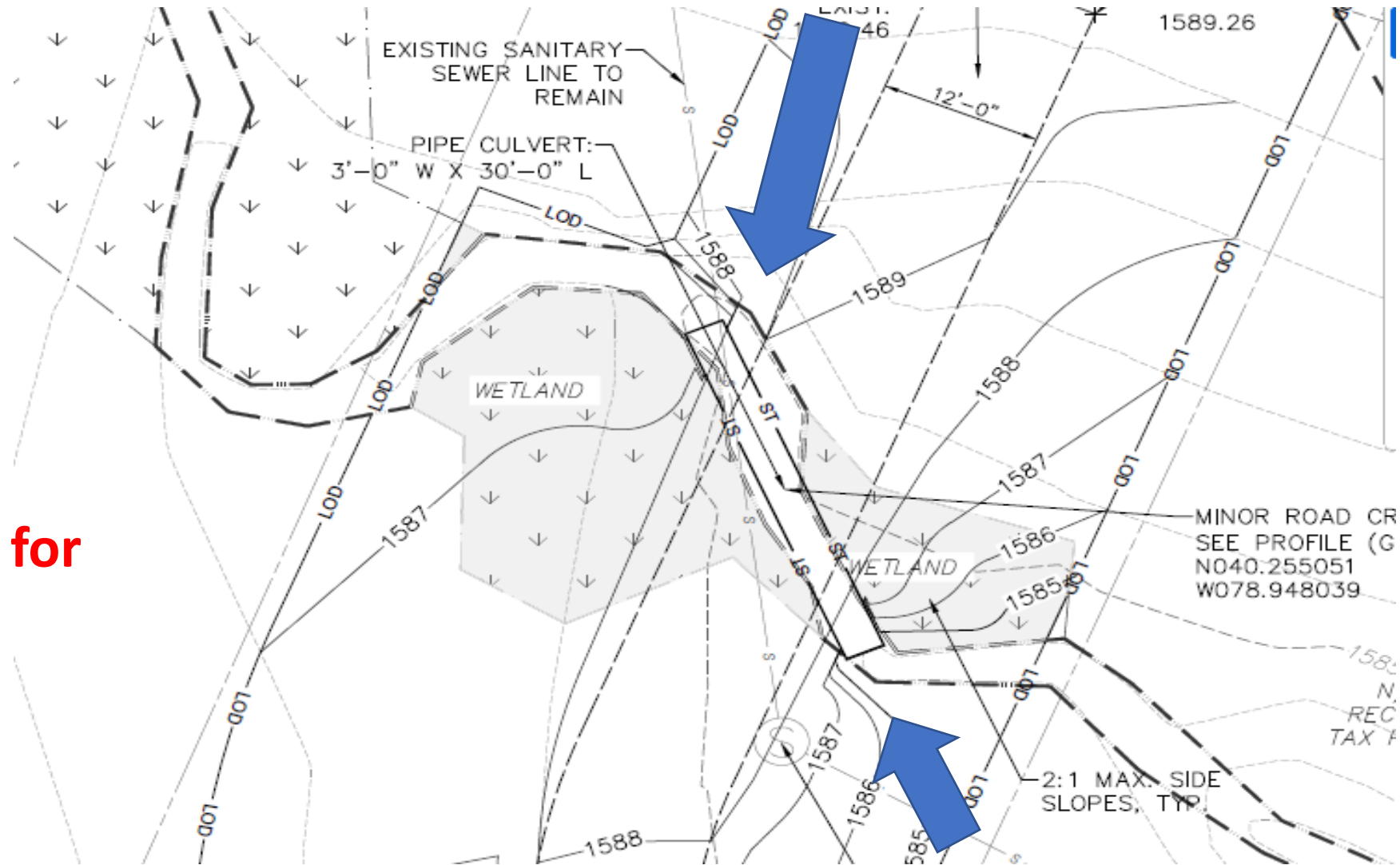

GP-7 Eligibility

- Sites/activities where GP-7 is not eligible:
 - Stream Enclosures (Culvert 100 LF or more in length)
 - EV Streams
 - Crossings located in a Drainage Area greater than 1 sq. mile
 - Crossings located in a stream with a designated floodplain (Zone A/AE)
 - Wetland Crossings with an impact greater than 0.1 acre or cumulative wetland impacts are greater than 0.25 acre
 - Phased projects consider all planned/potential minor road crossings for totals

GP-8 Temporary Road Crossings



- Design
 - Stream Crossings
 - Wetland Crossings
 - Mixed Resource Crossings
- Restoration & Removal

GP-8 Temporary Road Crossings

Design

Temporary Road Crossing of a Stream:

- Minimum 12" diameter
- Maximum diameter to be used as allowed by bank height; or series of pipes or bridge required
- Must allow for overtopping within the stream channel



GP-8 Temporary Road Crossings

Design

Temporary Road Crossing of a Wetland:

- Timber mats are the preferred crossing method where hydrology is not an issue; swampmats/yakmats are also acceptable
- Avoiding Soil Compaction is the goal
- Crossing method should be identified in application and typical drawing provided with plans



GP-8 Temporary Road Crossings

Design

Temporary Road Crossing with Mixed Resources:



- Each resource type should use an appropriate temp, crossing method
- Fill for approaches within a wetland should be minimized to what is necessary for stability of the stream crossing

GP-8 Temporary Road Crossings

Restoration & Removal of a Temporary Crossing:

- The crossing must be restored to original or better conditions within 5 days, after use is no longer needed.
- All temporary crossings must be removed and restored within 1-year of acknowledgement



- **Common Issues**
 - Bridges & Culverts
- **Operation & Maintenance**
- **Eligibility**



Common Issues for Bridges & Culverts

- Changes to Waterway Opening
 - Form: 3150-PM-BWEW0552B
 - H&H Analysis
- When to use GP-08?
 - Temporary Crossing for access or Construction purposes in LOD vs Access to the site or Vehicle traffic outside of LOD for GP-11
- Other GPs
 - GP-4/Outfall or Appurtenant Structure?
 - GP-3 for RipRap





Operation & Maintenance of a Bridge or Culvert:

- All permitted structures are required to be operational and maintained properly
- If major repairs or modifications are required to the structure new authorizations may also be required
- DEP has standards for channel cleaning
- No permit required for simple debris and trash removal
 - No heavy machinery in stream

Eligibility

- Change of Use
- Design Requirements same as other GPs with similar project scopes



Submitting GPs to DEP

- SW DEP reviews Fayette & Somerset GPs & all GP-11s
- All GPs can be submitted via e-permitting (for CCD or DEP review)
- DEP now has Public Upload with Payment

<https://www.dep.pa.gov/Business/Water/Waterways/Encroachments/PermittingAndAuthorizations/Pages/How-to-Submit-Permit-Applications-and-Authorizations.aspx>

Electronic Application Form Uploads

DEP now accepts online payments. Please submit new public upload submissions here: [Public Upload with Payment](#)

If this is a resubmission of something initially submitted before 12/15/2023, please resubmit here: [OnBase Public Upload](#)

Benefits of using the form include:

- Lower costs for DEP and applicants – no paper and mailing envelopes
- Better efficiency for DEP staff; applications can more easily be moved between staff to prevent backlog

Electronic
Submissions

eFACTS

GIS

Reports

Tools

Resources & Links:

DEP OnBase Upload with Payment

<https://www.dep.pa.gov/DataandTools/Pages/Application-Form-Upload.aspx>

DEP Waterways & Wetlands Program Website

<https://www.dep.pa.gov/Business/Water/Waterways/Encroachments/Pages/default.aspx>

DEP e-Library Waterways & Wetlands Ch 105 General Permits

<https://greenport.pa.gov/elibrary/GetFolder?FolderID=4050>

DEP Trenchless Technology Guidance:

<https://greenport.pa.gov/elibrary/GetFolder?FolderID=1039254>

PHMC Mapping Tool

<https://share.phmc.pa.gov/pashare/landing>

PAFBC Trout Streams Mapping Tool

<https://pfbc.maps.arcgis.com/apps/PublicGallery/index.html?appid=93d7c5b3c37b4ff78232493ba45186ae>

National Wetland Inventory (NWI):

[Wetlands Mapper | U.S. Fish & Wildlife Service \(fws.gov\)](#)

GP-1 –PAFBC Habitat Structure Sample Drawings

<https://www.fishandboat.com/Conservation/Habitat/Pages/Stream-Habitat.aspx>

Ch 105 General Permits

Questions?

Contact Information

SW Waterways & Wetlands Program

412-442-4000

Michala Hart

Env. Engineering Technician

412-442-4315

michahart@pa.gov