

## Mosaic Community Development Rain Garden

**Design Features:** Approximately 200 ft<sup>2</sup> rain garden with basket style grate and overflow pipe, and native pollinator plantings

**Date of Installation:** May 2024

**Location:** 414 Magee Avenue/ 106 South Street Jeannette, PA 15644

**Client:** Mosaic Community Development

**Cost:** \$5,000 DEP Educational Mini Grant, \$6,200 Katherine Mabis McKenna Foundation, \$2,000 Westmoreland Community Action Cash Match, and \$3,398 WCD In-Kind Match

**Project Partners:** Westmoreland Conservation District, Westmoreland Community Action, Competitive Edge Excavation, Katherine Mabis McKenna Foundation, and Mosaic Community Development

**Project Contact:** Hank Bradish, hank@wcdpa.com



*Post-construction of the rain garden with community involvement*

## Project Specifications

A 20' long, 10' wide, and 3.5' deep rain garden was constructed. An engineered soil mix composed of 50% topsoil, 30% sand, and 20% compost was placed in the bottom of the project to increase the infiltration rate of the rain garden. An overflow pipe with a basket style grate was also installed. This rain garden will control surface water runoff and roof water from the adjacent building. Students at Mosaic Community Development will also have the opportunity to learn about stormwater management. An education sign was also installed to teach about the functions of a rain garden.



*New Education Sign*

## Benefits/Performance Measures

The goals of this project included increasing the knowledge and outreach for stormwater issues, improving water quality and reducing the volume of stormwater runoff. The rain garden will control approximately 1800 gallons of stormwater.



Mosaic Community Development Rain Garden



*Pipe connection from the rain garden to an existing inlet*



*Excavation of the rain garden*

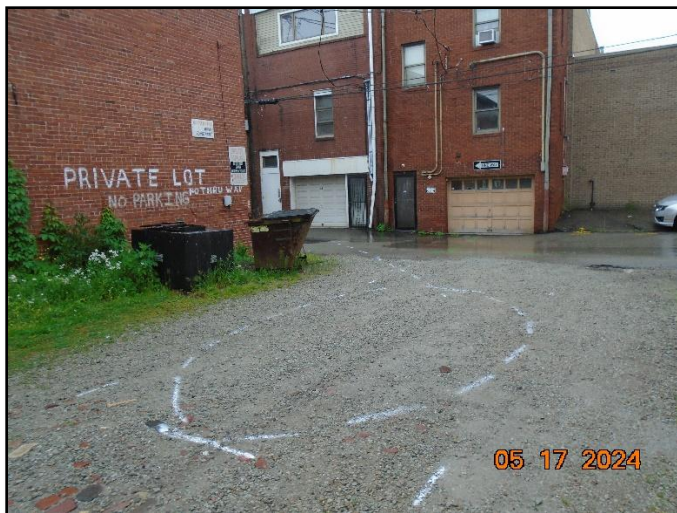

*Before Construction*



*After Construction*